

Notice de pose du faisceau électrique pour  
crochet d'attelage avec prise 13 voies

Version : ALL

Année : 05/2008 →

Réf : 174711

**BERLINGO II / PARTNER II**



0 H 30

Einbauanleitung elektrosatz Anhängervorrichtung mit Steckdosen 13-Polig  
Fitting instructions electric wiringkit towbar with socket 13-pin  
Montage-handleiding elektrokabelset voor trekhaak met contactdoos 13-polig

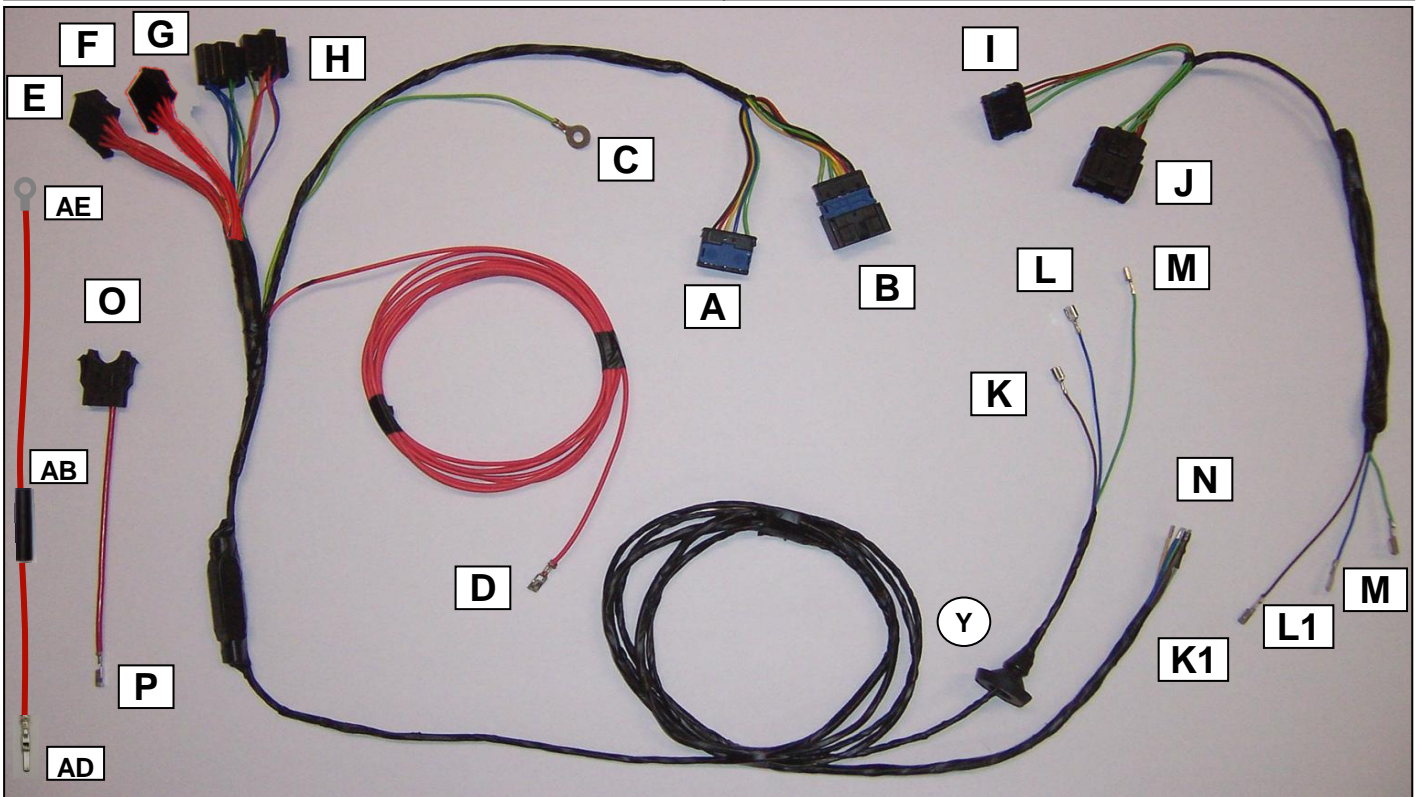
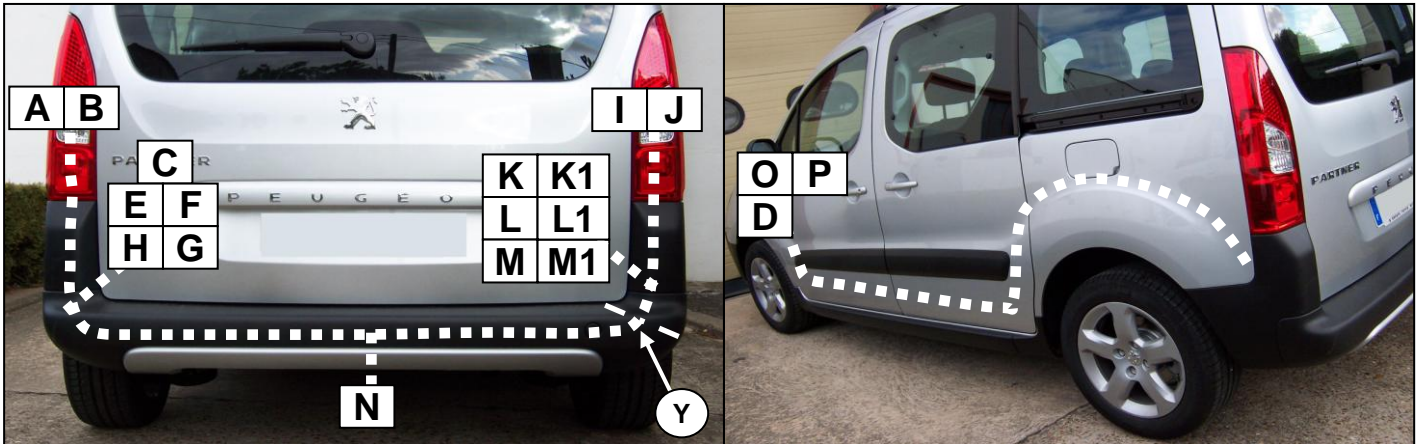

Liste des pièces / Teilliste / Part list / Onderdelenlijst :

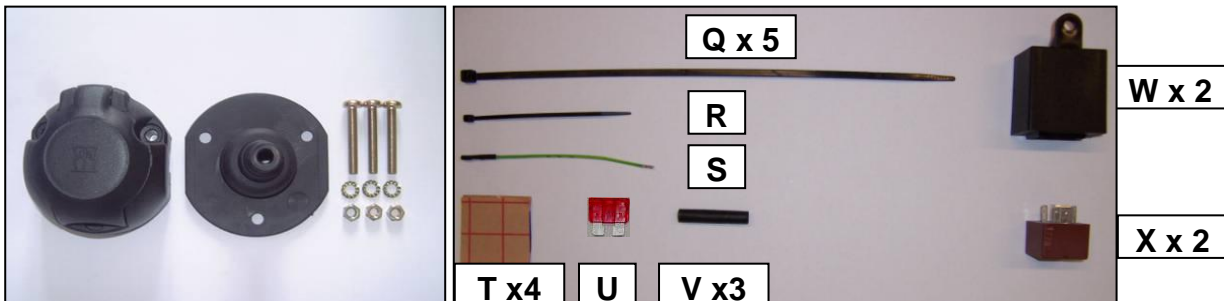

Cette notice ne peut être divulguée ou reproduite, partiellement ou en totalité, sans accord de la société.

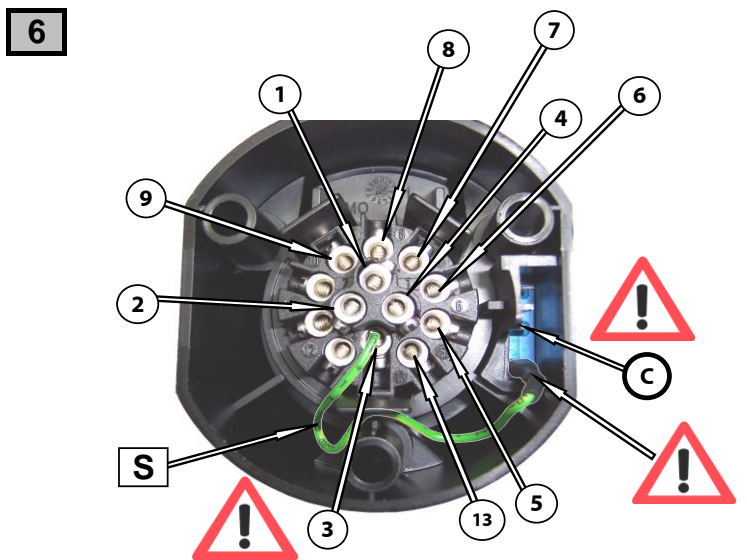
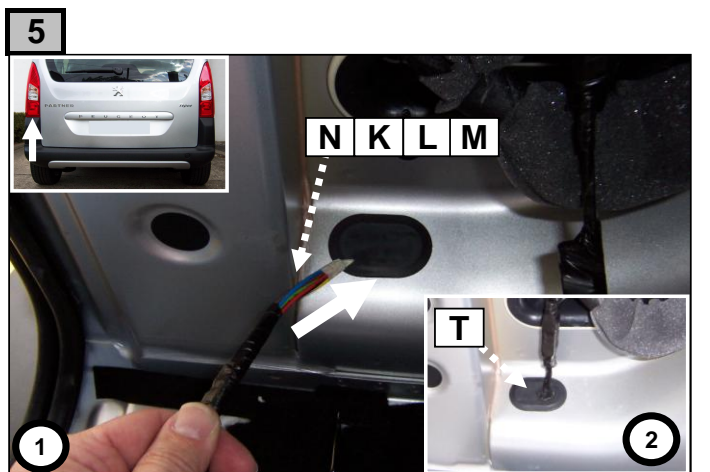
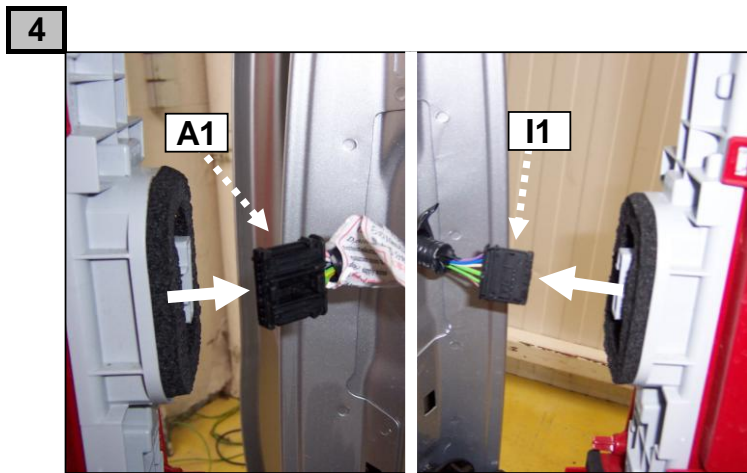
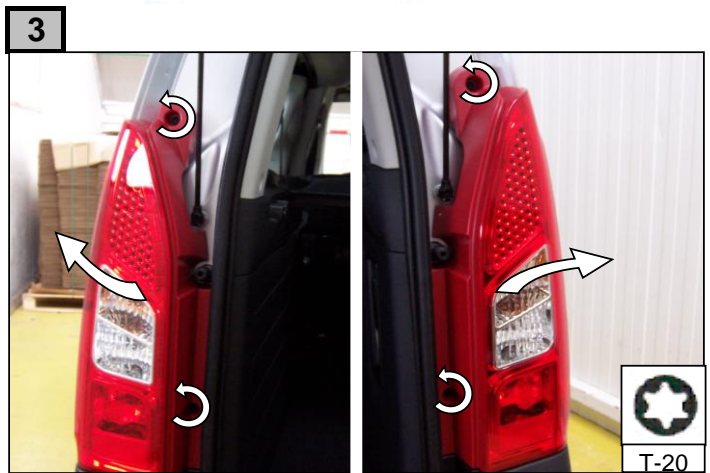
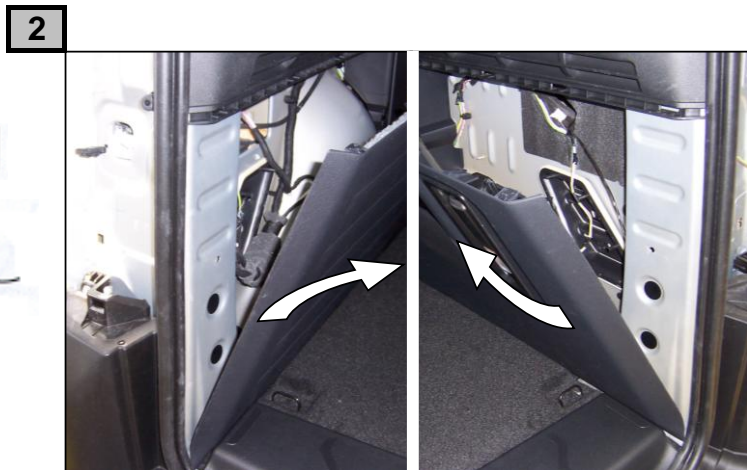
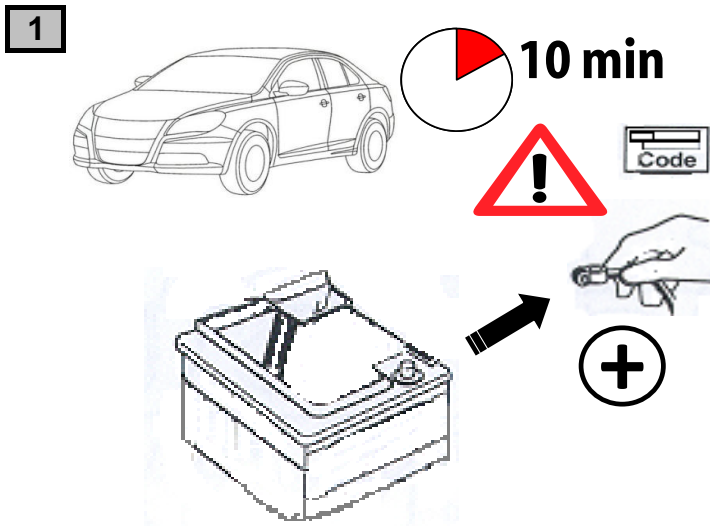

	<b>1/L</b>	<b>2/54g</b>	<b>3/31</b>	<b>4/R</b>	<b>5/58R</b>	<b>6/54</b>	<b>7/58L</b>	<b>8</b>	<b>9</b>	<b>13</b>	<b>(C)</b>
	21+5 W	21W	1 mm <sup>2</sup>	21+5 W	40 W	63 W	40 W	42 W	100 W	2 mm <sup>2</sup>	
<b>F</b>	Jaune	Bleu	Vert/jaune	Vert	Marron	Rouge	Noir	Blanc	Orange	Vert/jaune	Gris
<b>D</b>	Gelb	Blau	Grün/gelb	Grün	Braun	Rot	Schwarz	Weiß	Orange	Grün/gelb	Grau
<b>GB</b>	Yellow	Blue	Green/yellow	Green	Brown	Red	Black	White	Orange	Green/yellow	Grey
<b>NL</b>	Geel	Blauw	Groen/geel	Groen	Bruin	Rood	Zwart	Wit	Oranje	Groen/geel	Grijs
<b>P</b>	Amarelo	Azul	Verde/amarelo	Verde	Castanho	Vermelho	Preto	Branco	Cor de laranja	Verde/amarelo	Cinzentos
<b>I</b>	Giallo	Blu	Verde/giallo	Verde	Marrone	Rosso	Nero	Bianco	Arancio	Verde/giallo	Grigio
<b>E</b>	Amarillo	Azul	Verde/amarillo	Verde	Marron	Rojo	Negro	Blanco	Anaranjado	Verde/amarillo	Gris

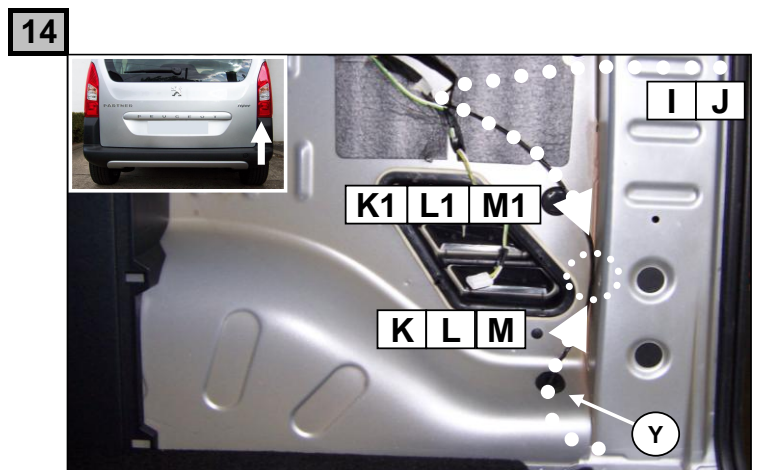
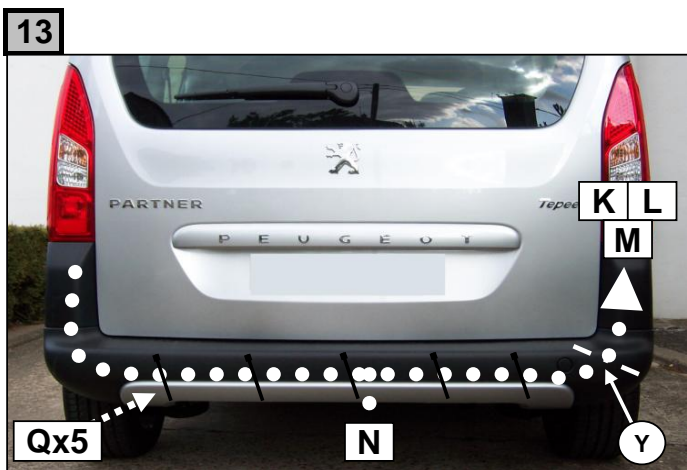
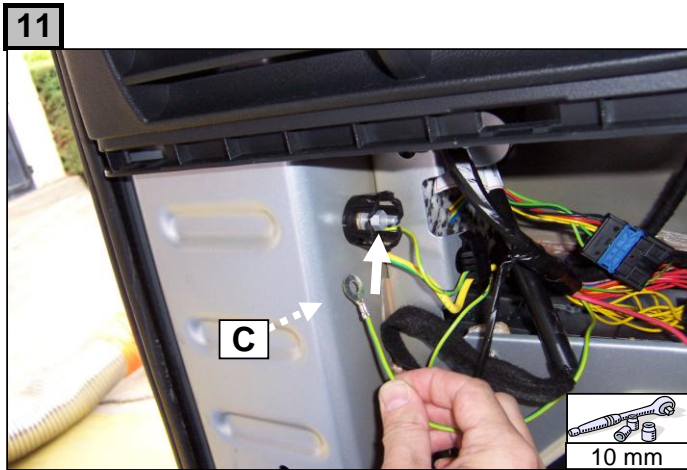
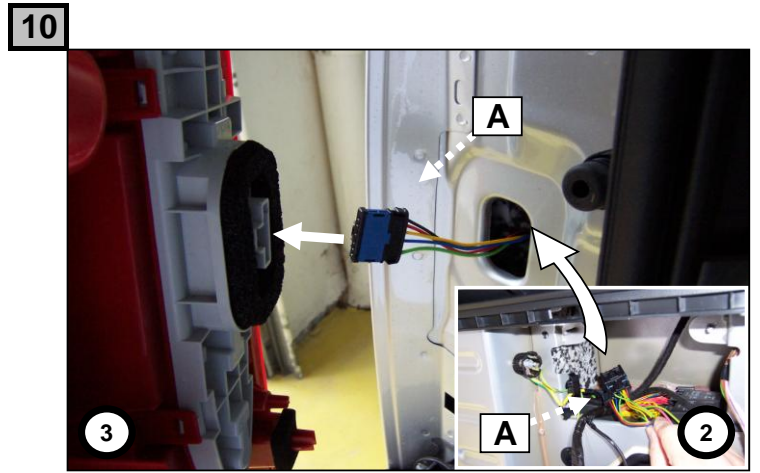
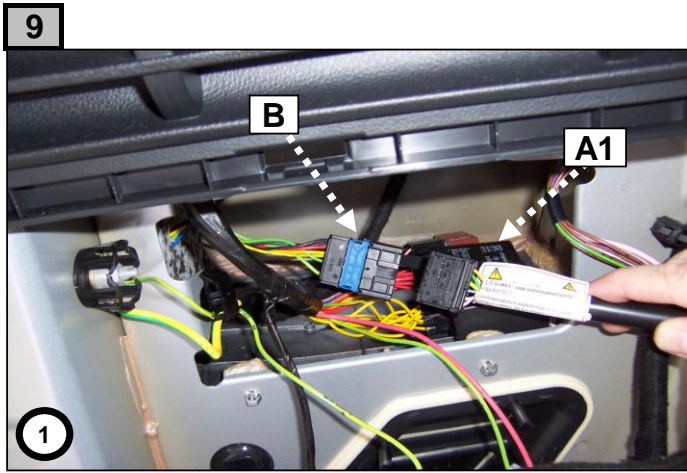
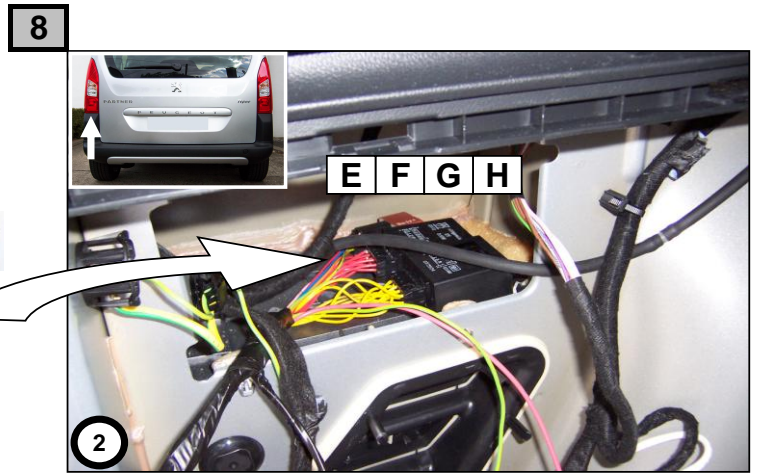
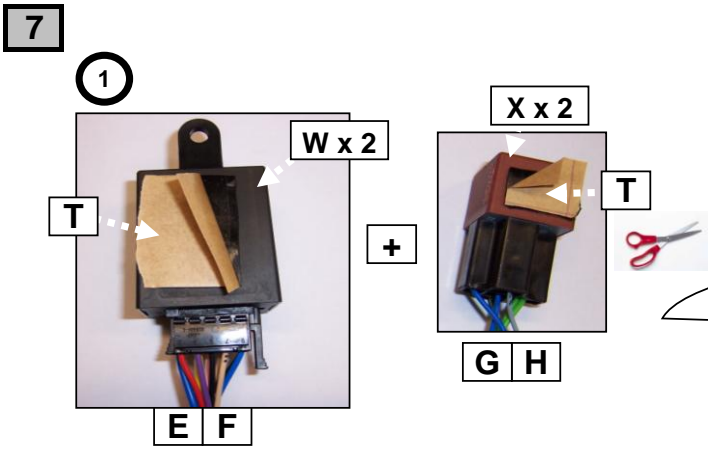

15

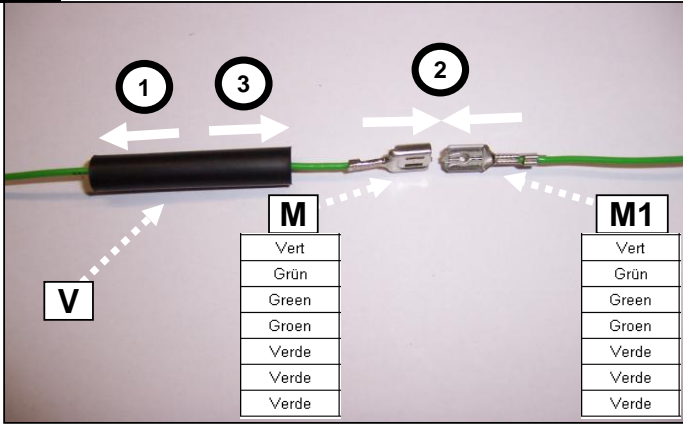

16

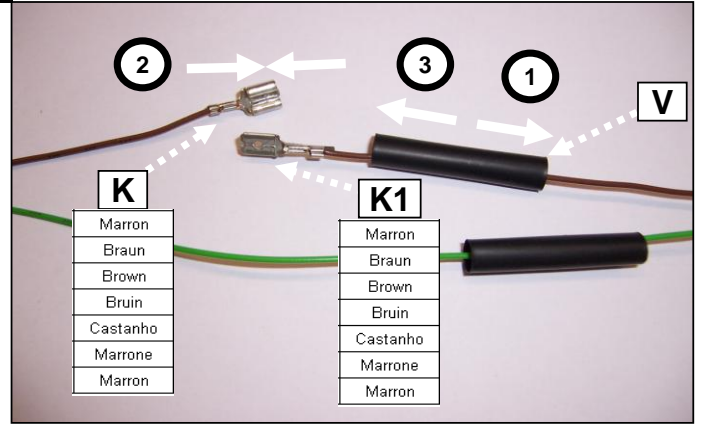

17

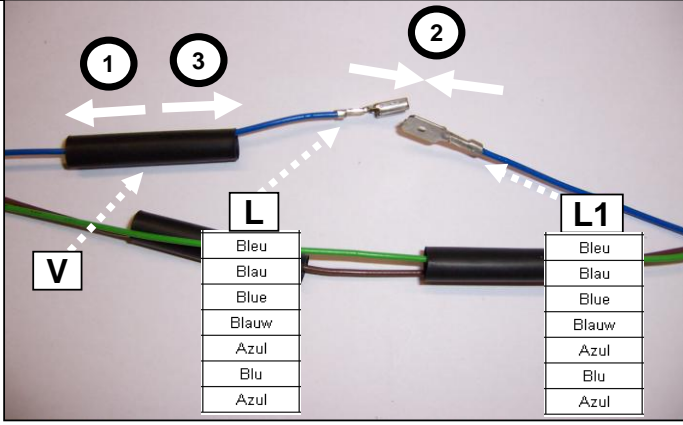

18

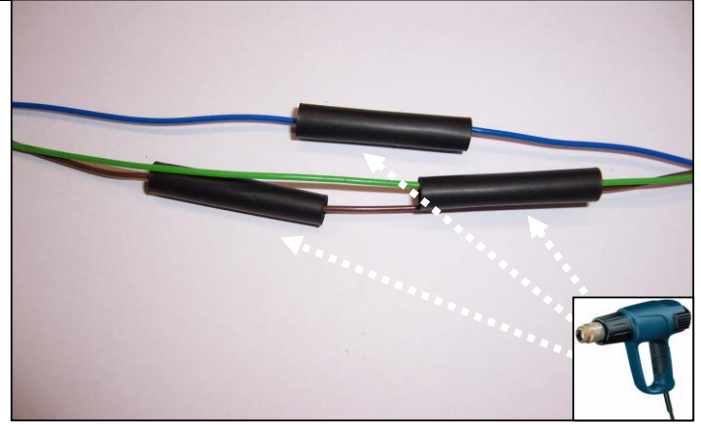

19

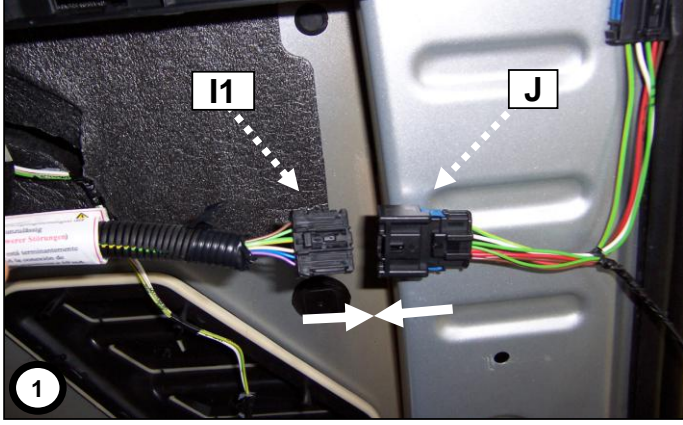

20

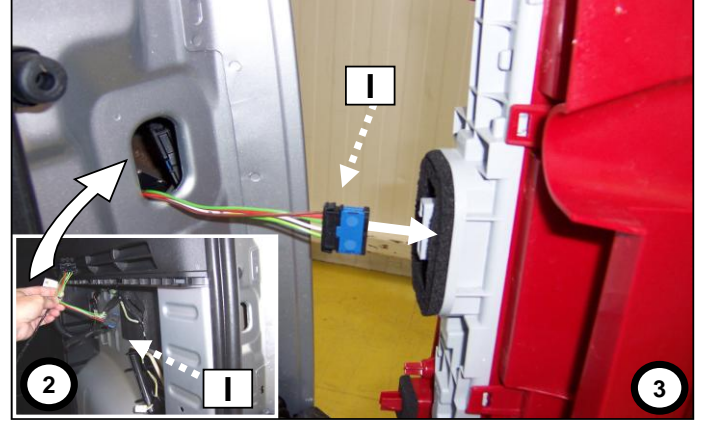

21



22

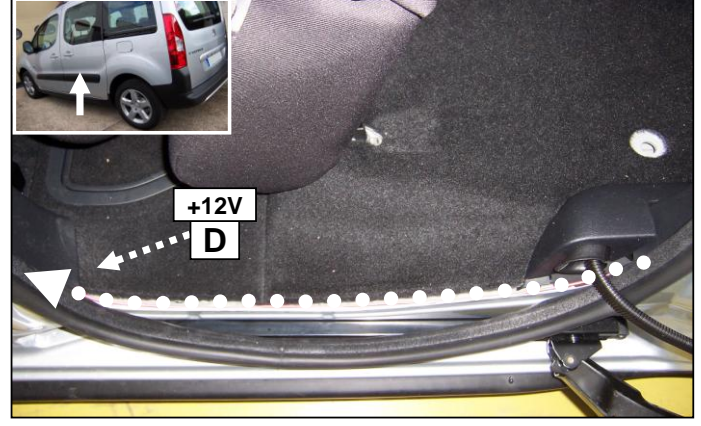

23

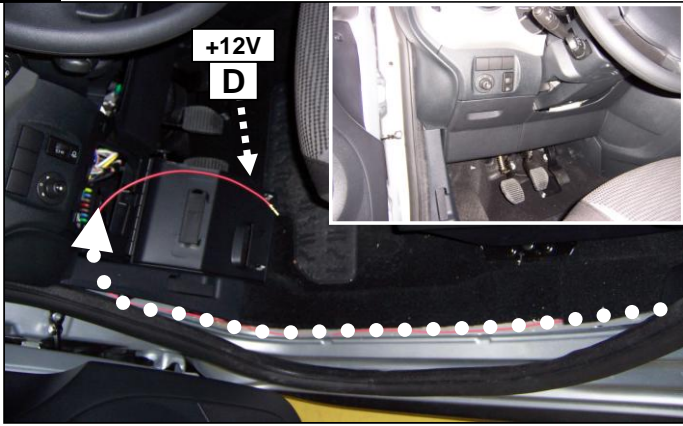

24

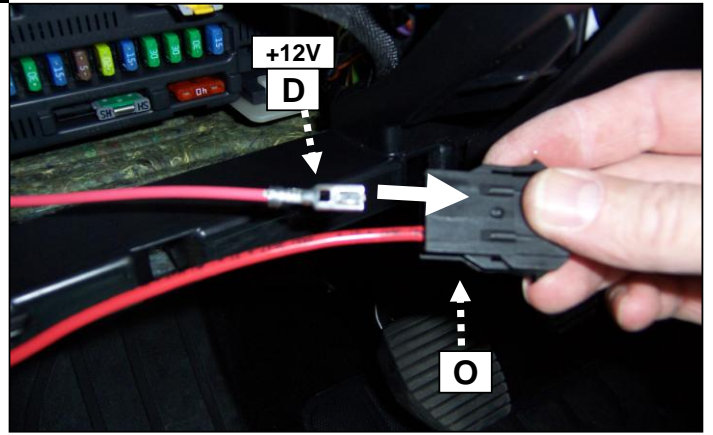

25

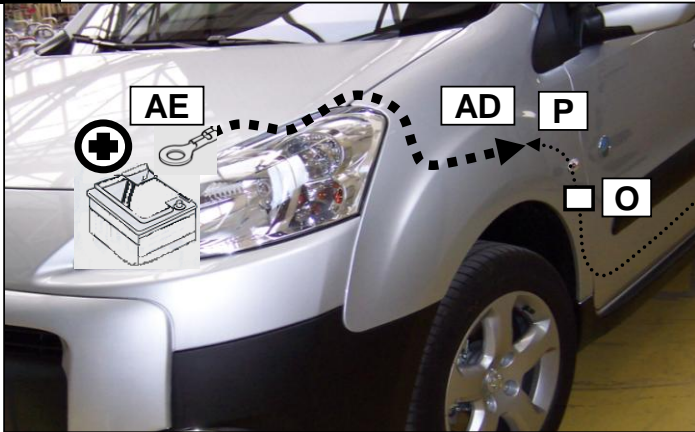

26

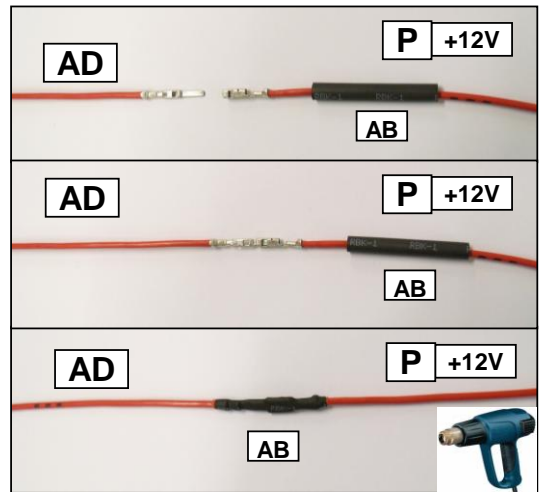

27

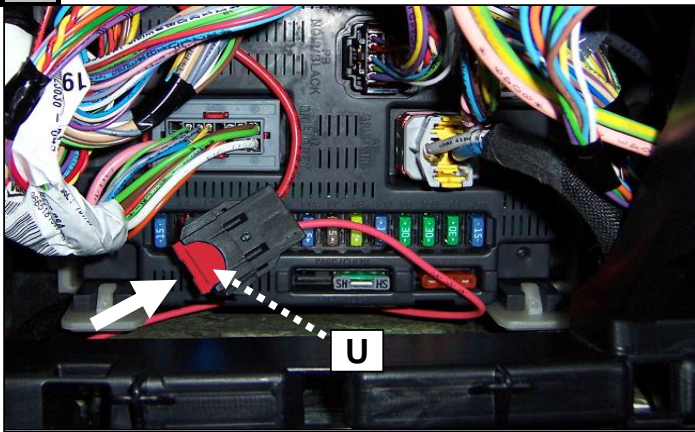

28

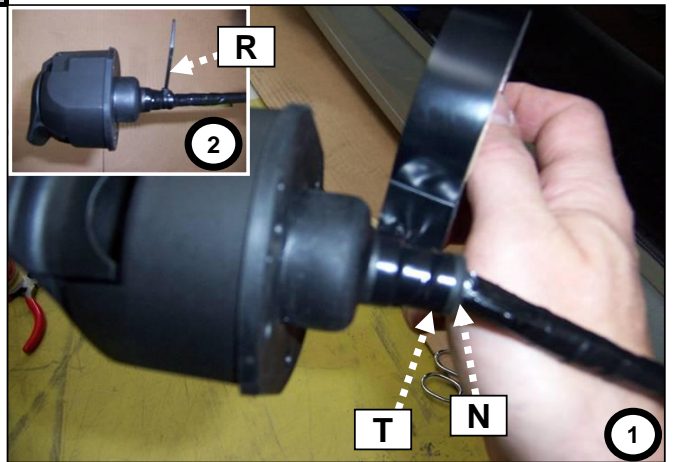

29

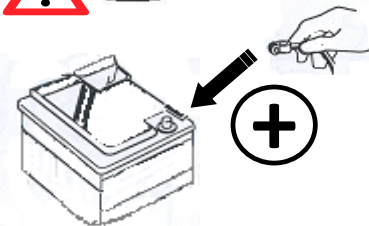

Contrôler les fonctions  
 Funktionen kontrollieren  
 Check functions  
 Controler functies

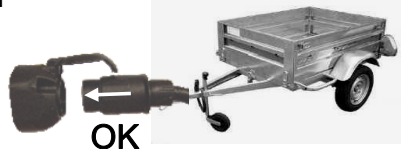

30

